

# Colorbond

# VERSACLAD EZ CLAD PANEL RIB

**Ceiling and wall everlasting**

**Cool, Sleek,  
Consistent  
Durability That  
Lasts**

Made of  
**GALVALUME 55™**,  
with 55% aluminum,  
guaranteed to outlast  
ordinary G.I. Sheets by 3  
to 6 lifetimes.

Double oven-baked  
epoxy primer.

Pre-painted with a  
choice of regular  
polyester or PVdF  
paint finish

Outstanding  
resistance to pests,  
rust, corrosion and  
fire. Does not warp or  
rot.

The most sensible  
and economical  
alternative to wood,  
concrete, gypsum  
and mineral fiber  
boards

*Fashionable yet exceptionally strong with the coolness of aluminum, make VERSACLAD, EZ CLAD and PANEL RIB ideal for siding, fascia and ceiling systems in industrial, institutional, commercial as well as in residential segments.*

*Its ease of installation, economy and durability translates to savings while maintaining the elegance and quality that you very well deserve. Both VERSACLAD and EZ CLAD have the concealed fastening advantage for a classier finish. While PANEL RIB boast of the widest profile available in the market at 1220 mm making it ideal for interior walling, partitions and ceiling.*

*Truly the quality that surrounds.*



Spanish Red



Tie Red



Orient Gold



Laguna White



Somar Beige



Pacific Blue



Baguio Green



**We have what it takes  
to help you put it all together**



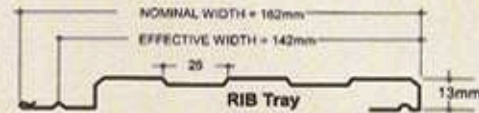
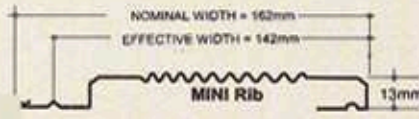

**GENERAL PRODUCT INFORMATION**

**BASE METAL TYPE:** Cold Rolled Steel: 275 MPa or 40,000 psi

**SUBSTRATE:** GALVALUME 55™; Aluminum-Zinc alloy-coated steel complying with ISO 9364. Also available in GALVABOND™; Lock Forming Quality (PNS 67: 1986)

**PAINT COATING:** **STANDARD**  
Double oven-baked epoxy primer and high grade polyester finish.

**COATING**

Top: Total of 25 microns  
Finish Coat: 20 microns  
Primer Coat: 5 microns  
Bottom: Total of 10 microns  
Backing Coat: 5 microns  
Primer Coat: 5 microns

**SALT SPRAY TEST RATING:** Class 1000 hours (passed 1000 hours of continuous exposure as per PNS 201: 1990), along with EZ Clad and Panel Rib, are the only pre-painted walling products in the market to have passed class 1000 rating.

**AVAILABLE THICKNESSES:**

**OPTIONAL**  
Premium Fluorocarbon (PVdF) paint finish on top of corrosion-resistant epoxy primer.

0.20 mm to 0.60mm  
Up to 13 m factory-cut custom length are available. Longer panels can be supplied provided satisfactory transport and on-site handling can be arranged.

**NOMINAL WIDTH:** 162 mm

**EFFECTIVE COVERAGE:** 142 mm

**AVAILABLE PROFILES:** VERSACLAD 1: mini rib design  
VERSACLAD 2: rib tray design

**APPLICATIONS:** Walling, Ceiling and Fascia

**STANDARD COLORS:** Pacific Blue, Samar Beige, Spanish Red, Tile Red, Laguna White, Orient Gold and Baguio Green. Special colors are available upon request.

**RECOMMENDED FASTENERS:** Steel Wafer Tek # 10 X 16 mm  
Wood Flat Head Nail #10 X 3/4"

(THICKER ZINC AND PAINT COATINGS AS WELL AS LENGTH SPANS CAN BE ARRANGED)

**ACCESSORIES for VERSACLAD AND EZ CLAD**

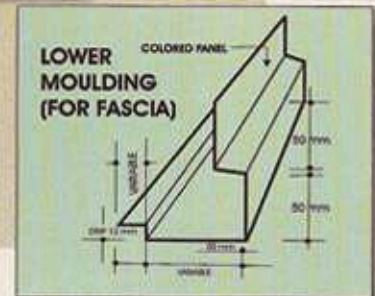
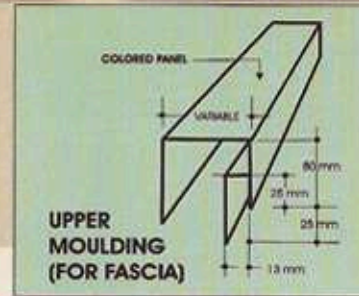
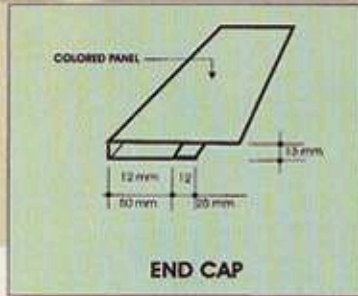
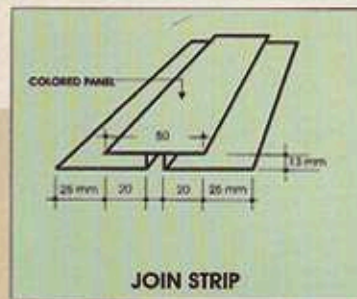
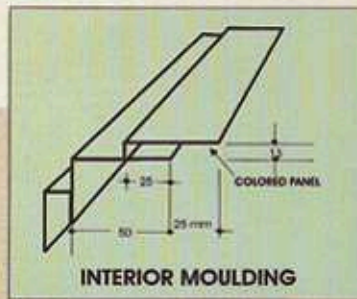
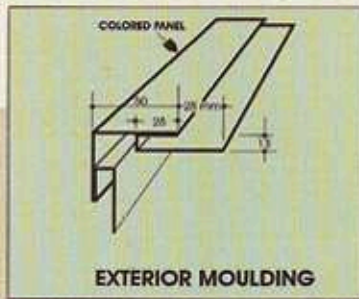

**INSTALLATION GUIDE**

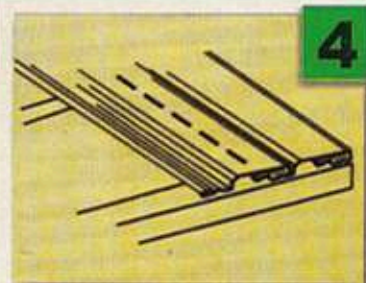
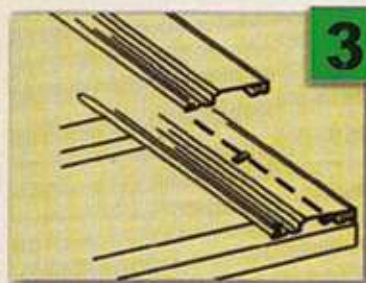
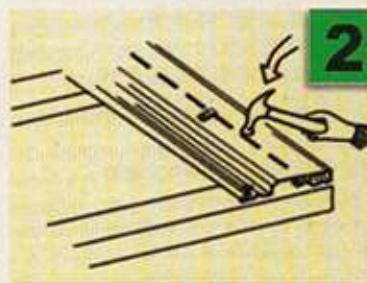
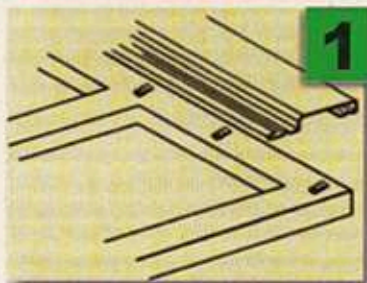

**FIXING PROCEDURE:**

For a first class job, ensure that the faces of all supports are in one plane.

VERSACLAD can be attached to the frame with flutes either vertical or horizontal. When fixing flutes horizontally, ensure that the top sheet overlaps the sheet under it.

If end laps are necessary because of very long runs, allow at least 75 mm lap.

**LOCATION OF FASTENERS:**

A fastener should be located either at the side or adjacent to it. For a quality finish, fasteners at the end or end laps of VERSACLAD sheets, should be located at every second valley.

At intermediate supports, four fasteners should be used equidistant across the sheet.

**SIDE LAP FASTENERS:**

Three types of side lapping methods are used, the overlapping flute, the jointing strip and the edge lap joint methods.

When using the overlapping or edge lap joint methods, side lap fasteners are required at 200 - 300 mm centers.

# EZ CLAD™

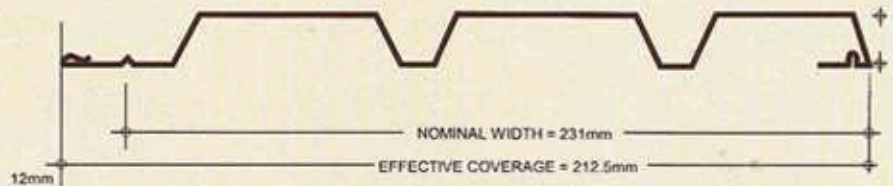

## GENERAL PRODUCT INFORMATION

**BASE METAL TYPE:** Cold Rolled Steel; 275 MPa or 40,000 psi

**SUBSTRATE:** GALVALUME 55™; Aluminum-Zinc Alloy coated steel complying with ISO 9364. Also available in GALVABOND™; Lock Forming Quality (PNS 67: 1986)

**PAINT COATING:** **STANDARD**  
Double oven-baked epoxy primer and high-grade polyester finish.

**COATING**

Top: Total of 25 microns  
Finish Coat: 20 microns  
Primer Coat: 5 microns  
Bottom: Total of 10 microns  
Backing Coat: 5 microns  
Primer Coat: 5 microns

**OPTIONAL**

Premium Fluorocarbon (PVdF) paint finish on top of corrosion-resistant epoxy primer

**SALT SPRAY TEST RATING:** Class 1000 hours (passed 1000 hours of continuous exposure as per PNS 201: 1990), along with Versaclad and Panel Rib, are the only pre-painted walling products in the market to have passed class 1000 rating.

**AVAILABLE THICKNESSES:** 0.20 mm to 0.60mm

**LENGTH:** Up to 13 m factory-cut custom lengths are available. Longer panels can be supplied provided satisfactory transport and on-site handling can be arranged.

**NOMINAL WIDTH:** 231 mm

**EFFECTIVE COVERAGE:** 212.50 mm

**APPLICATIONS:** Walling and Ceiling

**STANDARD COLORS:** Pacific Blue, Samar Beige, Spanish Red, Tile Red, Laguna White, Orient Gold and Baguio Green. Special colors are available upon request.

**OTHER METAL COATINGS AND FINISH AVAILABLE:**

METAL	FINISH
Galvanized Iron	Plain
Copper	Plain
Brass	Plain
Stainless Steel	Plain
Aluminum	Mill, Satin, Anodized

**RECOMMENDED FASTENERS:**

Steel	Water Tek # 10 X 16 mm
Wood	Flat Head Nail #10 X 3/4"

(THICKER ZINC AND PAINT COATINGS AS WELL AS LENGTH SPANS CAN BE ARRANGED)

## INSTALLATION GUIDE

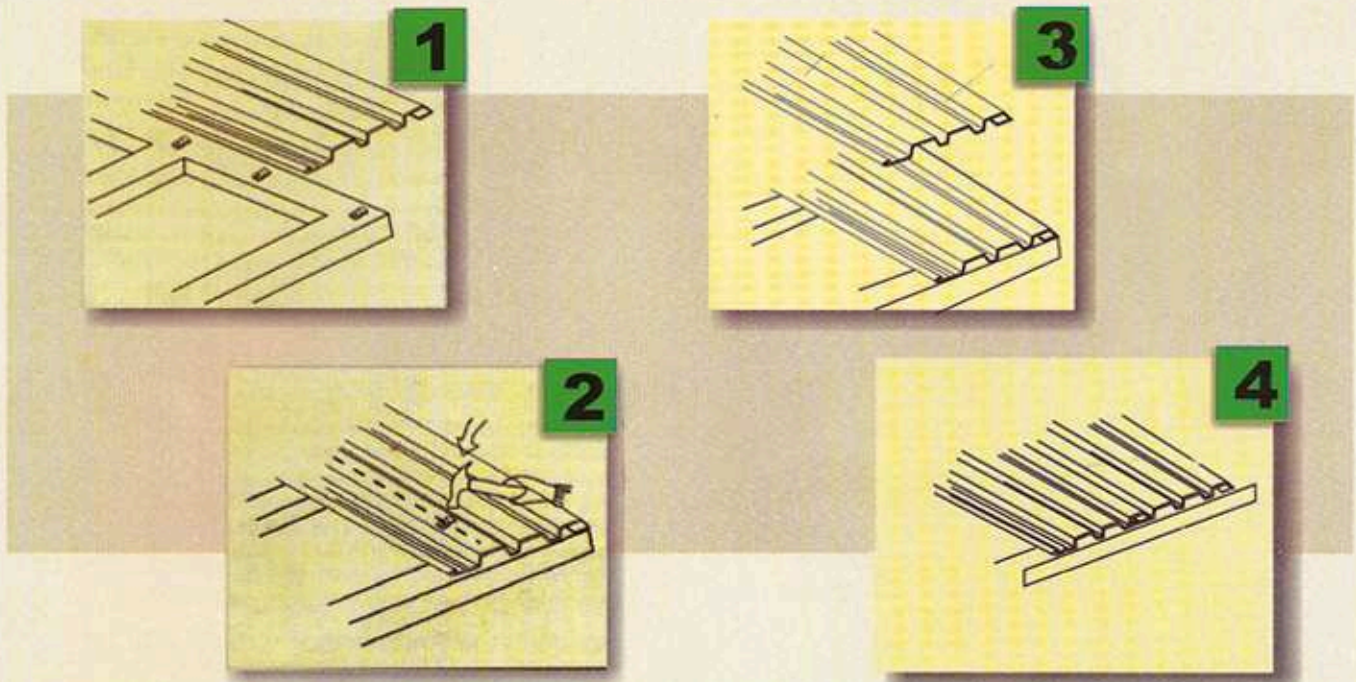

### FIXING PROCEDURE:

For a first class job, ensure that the faces of all supports are in one plane.

EZ CLAD can be attached to the frame with flutes either vertical or horizontal. When fixing flutes horizontally, ensure that the top sheet overlaps the sheet under it.

If end laps are necessary because of very long runs, allow at least 75 mm lap.

### LOCATION OF FASTENERS:

A fastener should be located either at the side or adjacent to it. For a quality finish, fasteners at the end or end laps of EZ CLAD sheets, should be located at every second valley.

At intermediate supports, four fasteners should be used equidistant across the sheet.

### SIDE LAP FASTENERS:

Three types of side lapping methods are used, the overlapping flute, the jointing strip and the edge lap joint methods.

When using the overlapping or edge lap joint methods, side lap fasteners are required at 200 - 300 mm centers.

## GENERAL PRODUCT INFORMATION

**BASE METAL TYPE:** Cold Rolled Steel: 550 MPa or 30,000 psi

**SALT SPRAY TEST RATING:** Class 1000 hours (passed 1000 hours of continuous exposure as per PNS 201: 1990), along with EZ Clad and Versaclad, are the only pre-painted walling products in the market to have passed class 1000 rating

**STANDARD COLORS:** Pacific Blue, Samar Beige, Spanish Red, Tile Red, Laguna White, Orient Gold and Baguio Green. Special colors are available upon request

**SUBSTRATE:** GALVALUME 55™: Aluminum-Zinc alloy-coated steel complying with ISO 9364. Also available in GALVABOND™: Lock Forming Quality (PNS 67: 1986)

**OTHER METAL COATINGS AND FINISH AVAILABLE:**

METAL	FINISH
Galvanized Iron	Plain
Copper	Plain
Brass	Plain
Stainless Steel	Plain
Aluminum	Mill, Satn. Anodized

**PAINT COATING. STANDARD**  
Double oven-baked epoxy primer and high grade polyester finish

**AVAILABLE THICKNESSES:** 0.30 mm to 0.40mm

**WIDTH:**

Feed Width	Nominal Width	Effective Width	Coverage
915 mm	895 mm	858 mm	
1220 mm	1195 mm	1144 mm	

**RECOMMENDED FASTENERS:**

Steel	Tek Screw #10 10-24 X 18 mm. Wafer Head
Wood	Tek Screw #3 11 X 50 mm
Blind Rivet	3/32" x 3/8"

**COATING**  
Top: Total of 25 microns  
Finish Coat: 20 microns  
Primer Coat: 5 microns  
Bottom: Total of 10 microns  
Backing Coat: 5 microns  
Primer Coat: 5 microns

**LENGTH:** Up to 7.32 m factory-cut custom lengths are available provided satisfactory transport and on-site handling can be arranged

**MAXIMUM SUPPORT SPACING:** Refer to stud spacing Table indicated below

**OPTIONAL**  
Premium Fluorocarbon (PVdF) paint finish on top of corrosion-resistant epoxy primer

**APPLICATIONS:** Ceiling and Sidings

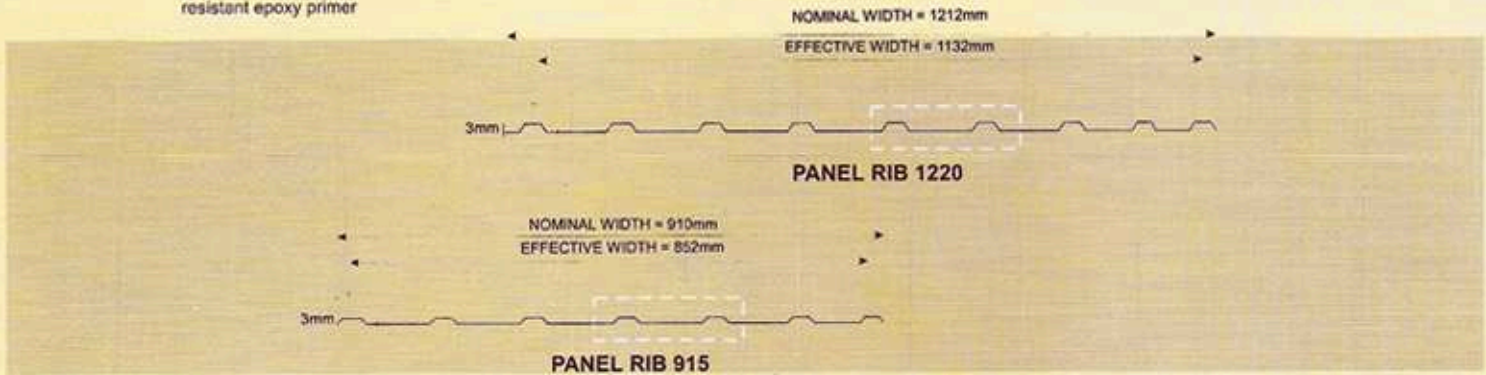

## FIXING PROCEDURES OF PANEL RIBS

1. Check the alignment of the studs with vertical spacing specified by an engineer.
2. For horizontal laying, start from the bottom to top. Begin from left end to the right or vice versa, if the layout is vertical.
3. Check the end alignment of panel ribs by using string line bob.
4. Fasten the profile by using either self-drilling tek screw, ordinary screw, common wire nail for wooden studs or by blind rivet, for steel studs.
5. Attach the mouldings at every end of the panel.
6. Retouch the scratched or damaged surfaces with acrylic touch-up paint.

THICKNESS (mm)	LOCATION	STUD SPACING (mm O.C.)
0.30	EXTERIOR	N/A
	ZONE I *	500
	ZONE II *	600
	INTERIOR	1000
0.40	EXTERIOR	400
	ZONE I *	600
	ZONE II *	1000
	INTERIOR	1200

## ACCESSORIES

